

1x A		1x B	
1x C		1x D	
2x E		26x G	18x H
2x F			

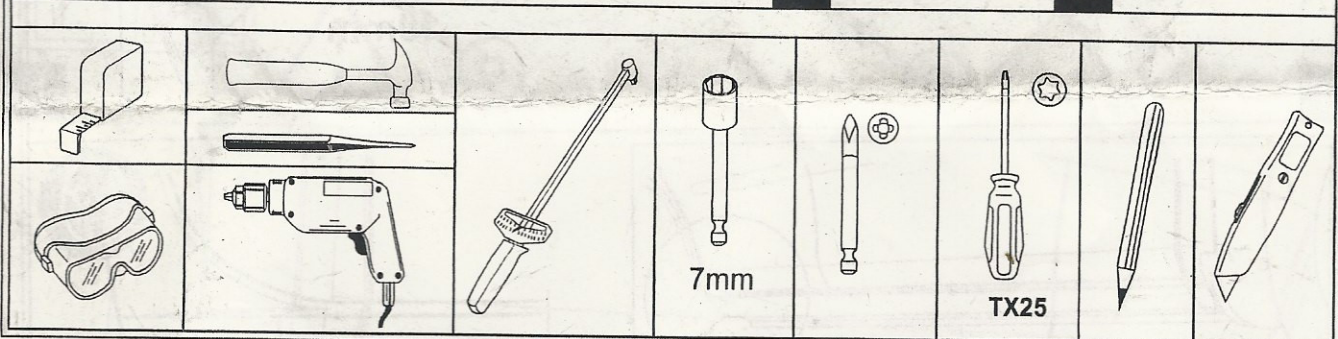

GB	INSTALLATION INSTRUCTION	SIDE SILL MOLDING
F	INSTRUCTIONS D'INSTALLATION	BAS DE MARCHÉ
E	INSTRUCCIONES DE INSTALACIÓN	MANDIL LATERAL

Subject to alteration without notice
Sujet à modification sans préavis
Sujeto a modificación sin aviso

05-01-2003

© DAIMLERCHRYSLER

K6858828

1 OF 4

40115

LEFT SIDE SHOWN, RIGHT SIDE TYPICAL

GB NOTES: Wash and thoroughly dry vehicle. For best results, vehicle should be free of damage (dents, scuff, creases, fractures, etc.). Lift vehicle onto a secure hoist. Rear wheels need to be removed.

F REMARQUES: Laver le véhicule et le sécher complètement. Pour obtenir de meilleurs résultats, le véhicule ne doit pas présenter de dommages (bosselures, éraflures, plis, cassures, etc.). Soulever le véhicule et le mettre sur un élévateur fixe. Les roues arrière doivent être enlevées.

E NOTAS: Lave y seque cuidadosamente el vehículo. Para que el resultado sea óptimo, el vehículo no debe presentar daño (abolladuras, raspones, rayas, grietas, etc.). Levante el vehículo en un montacargas. Se deben quitar las ruedas traseras.

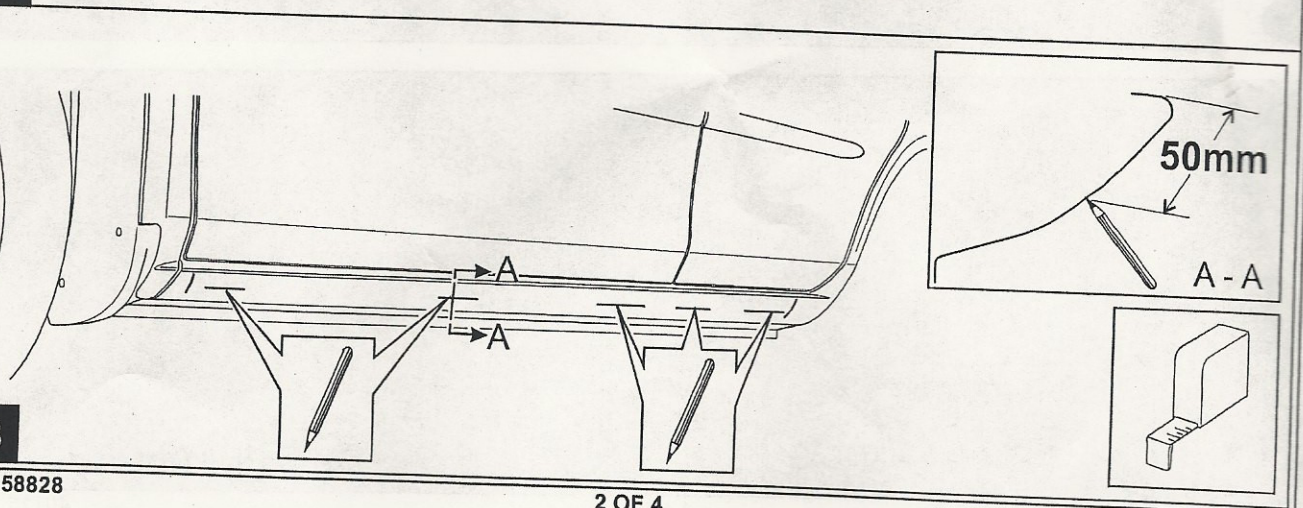
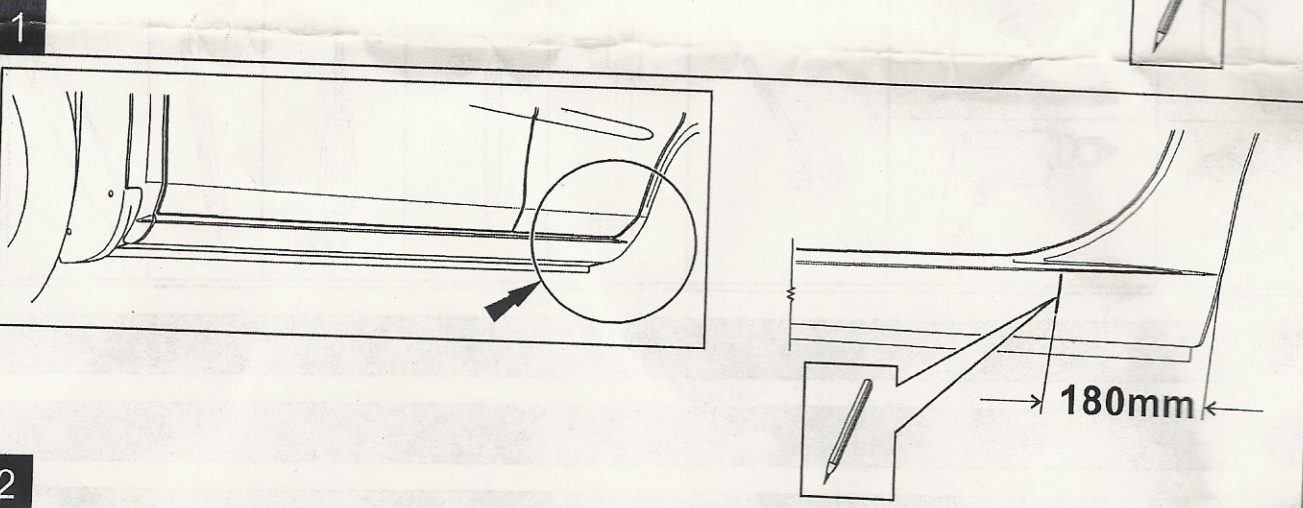
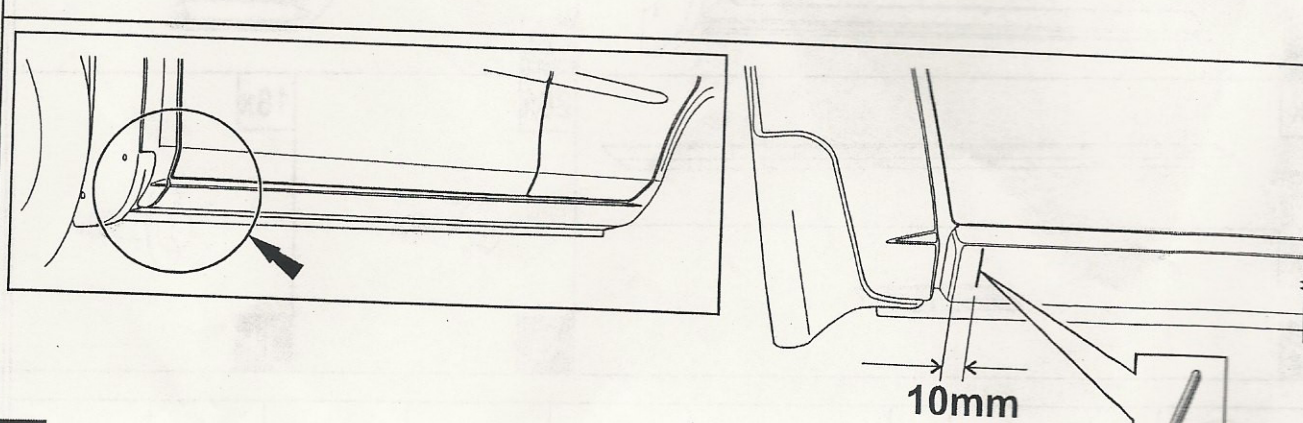

K6858828

2 OF 4

40115

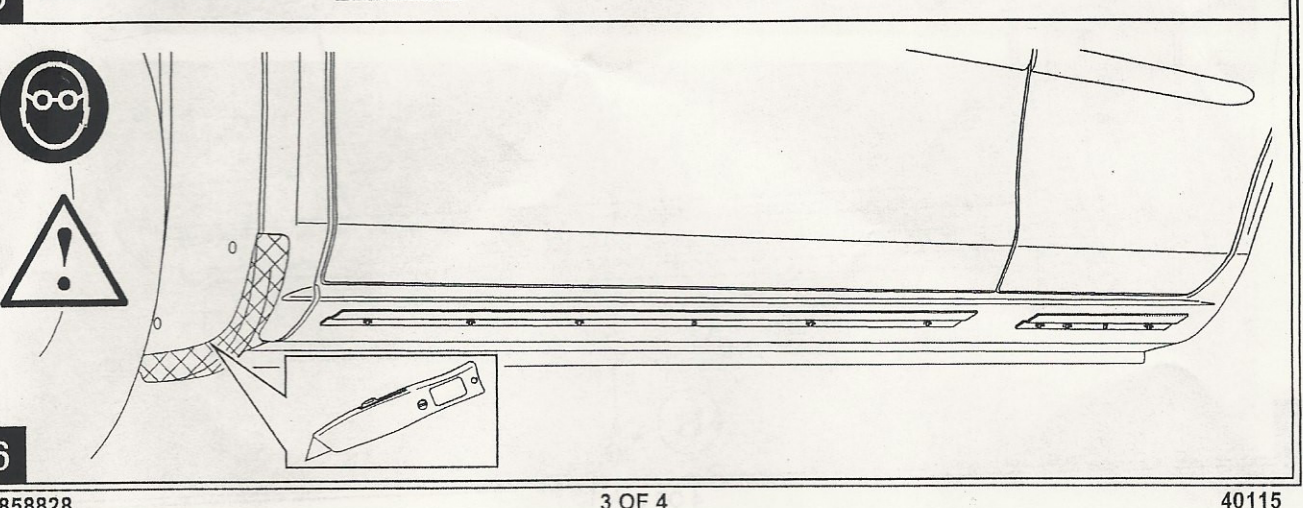
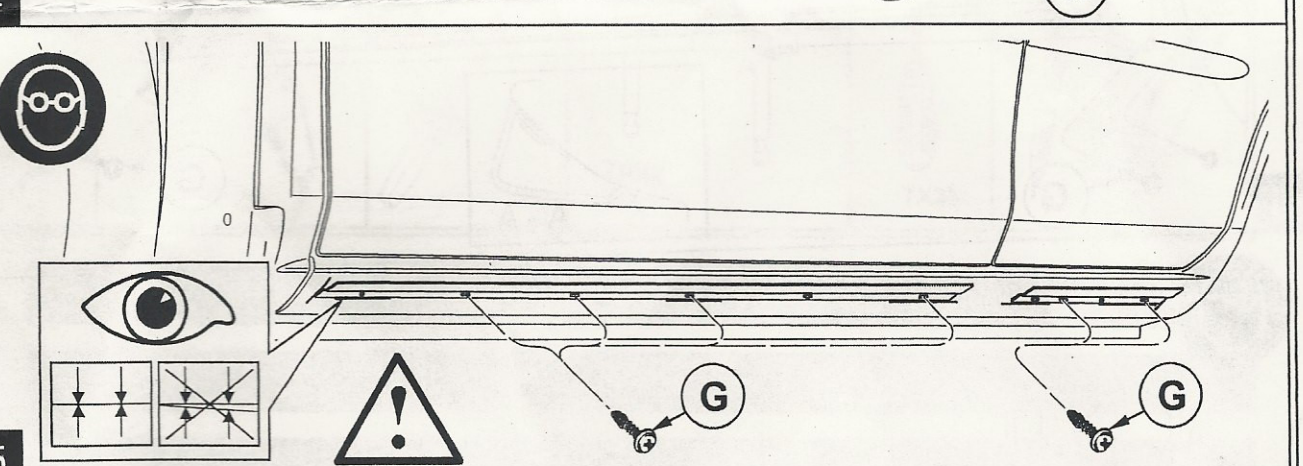
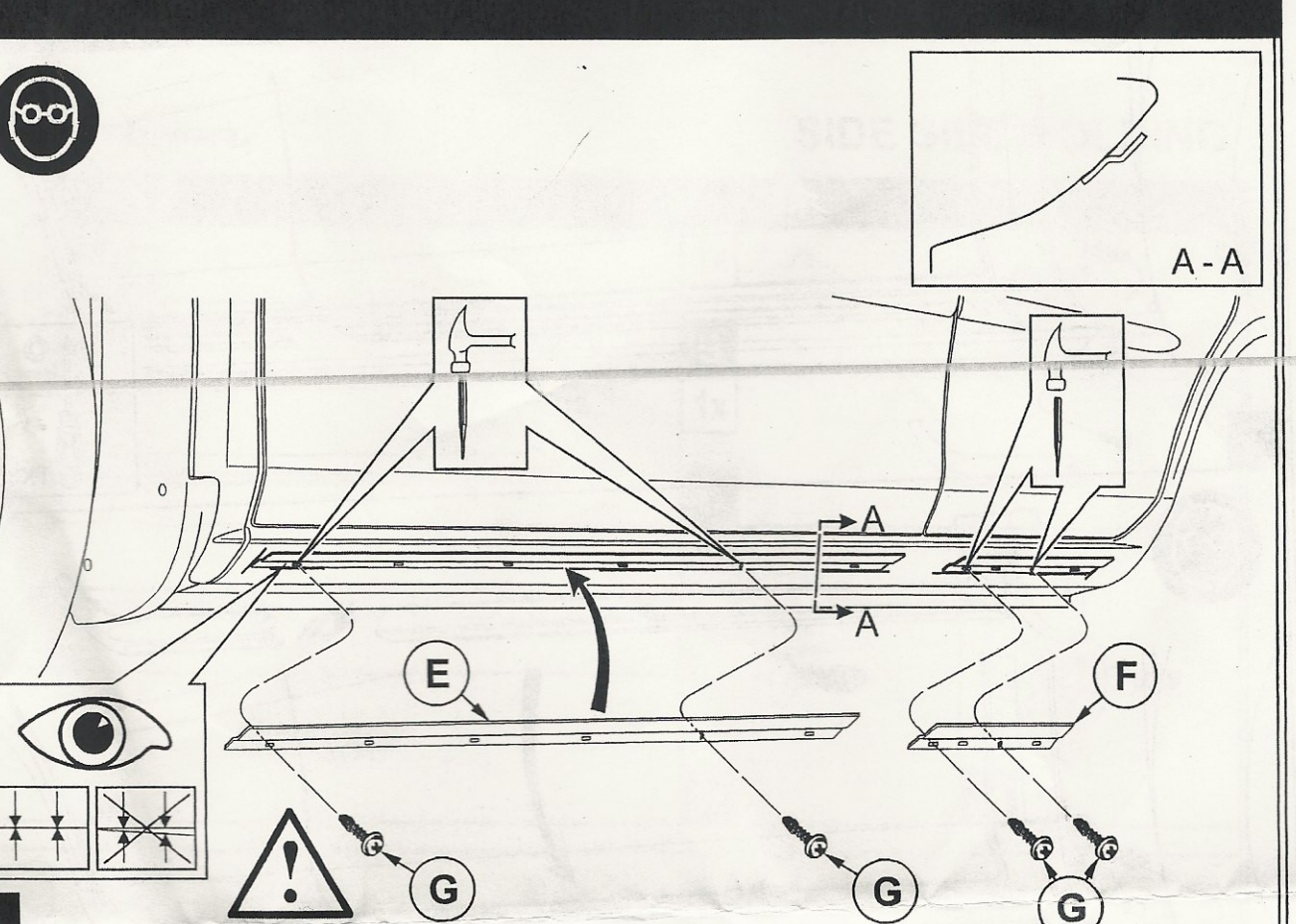

K6858828

3 OF 4

40115

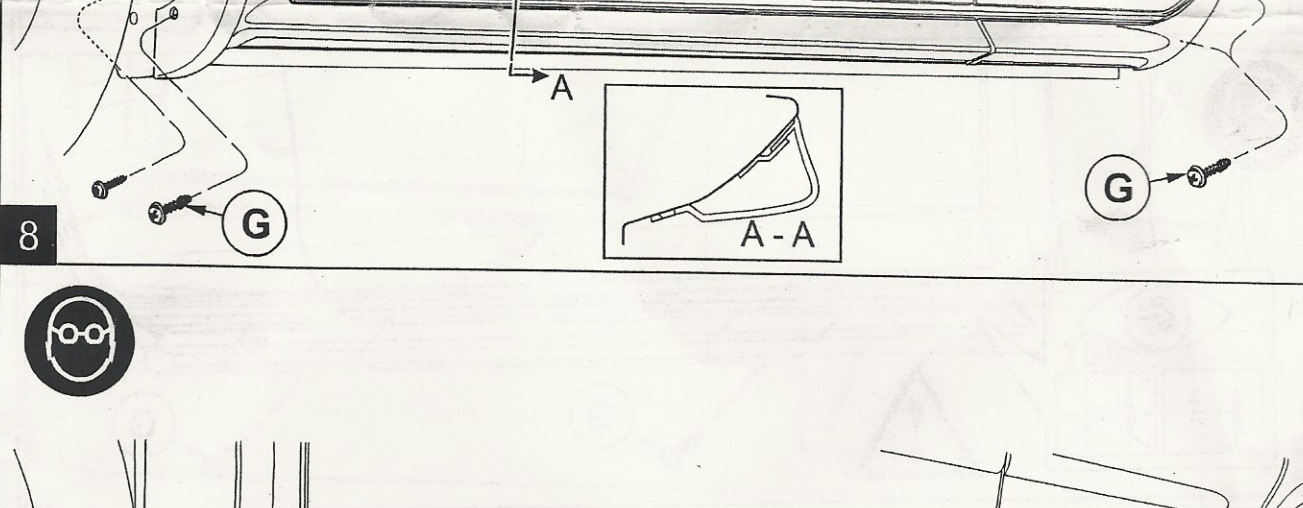
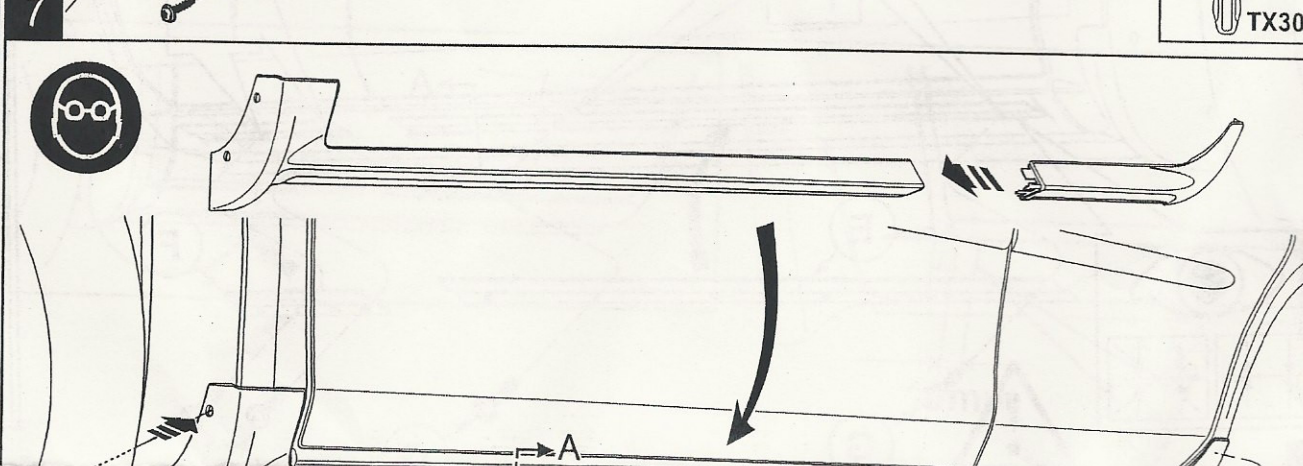
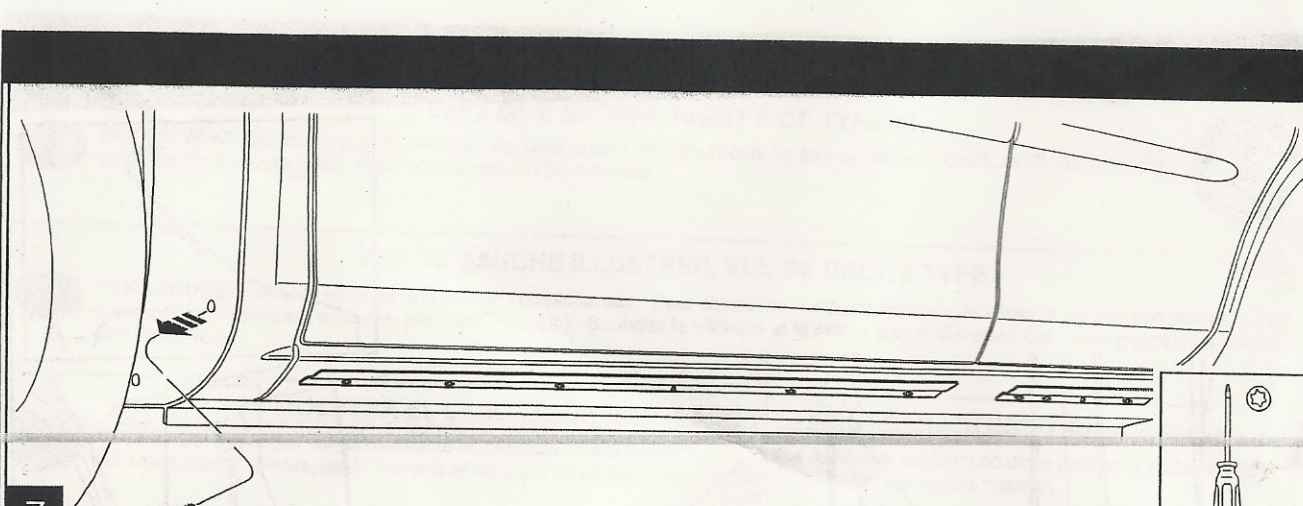

K6858828

4 OF 4

40115